

senzor[®]

Uživatel'ský manuál



Dial'kový ovládač

DO - 2

2 x 1.5V

CN: 09.02.04.000

var.1/2015

1. Základné údaje

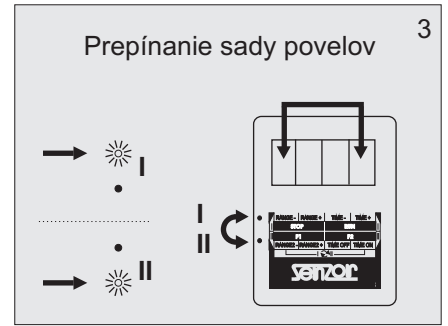
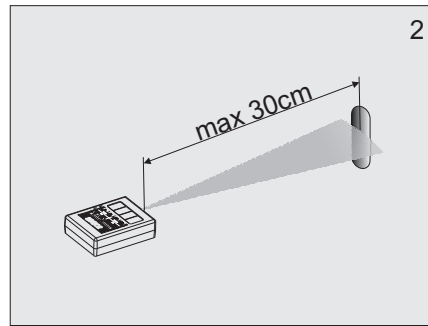
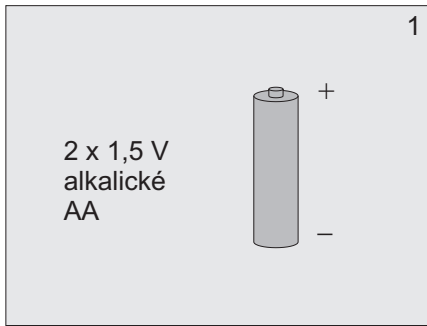

2. Nastavovanie parametrov

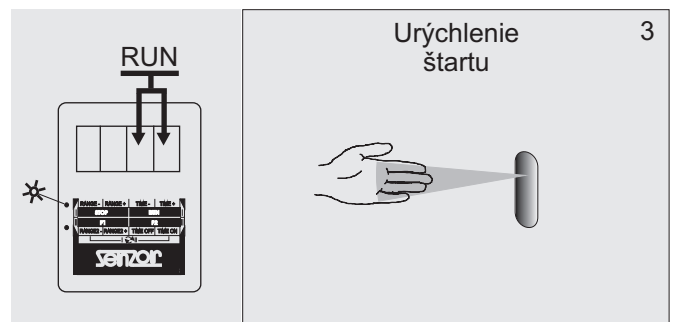
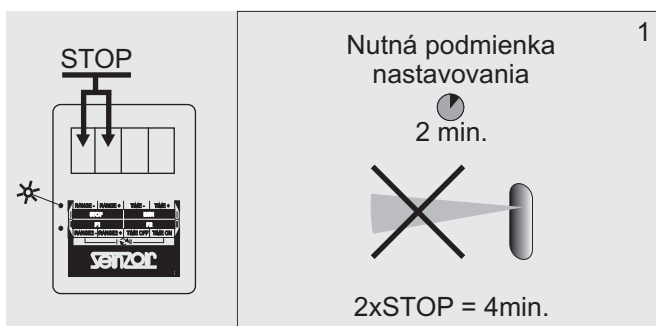
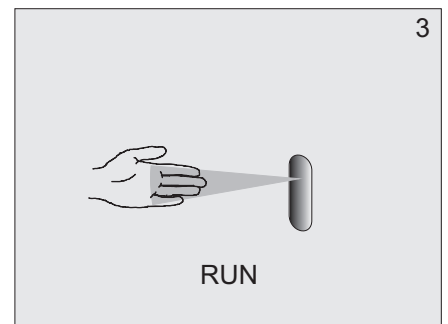
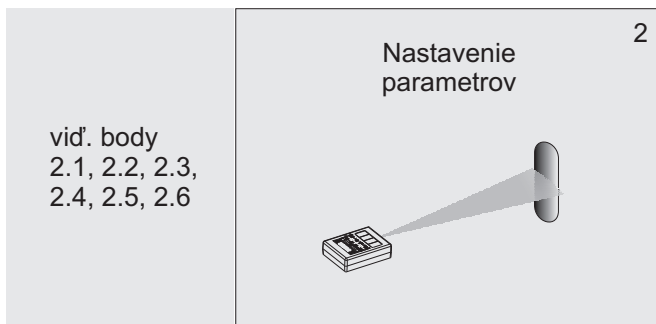
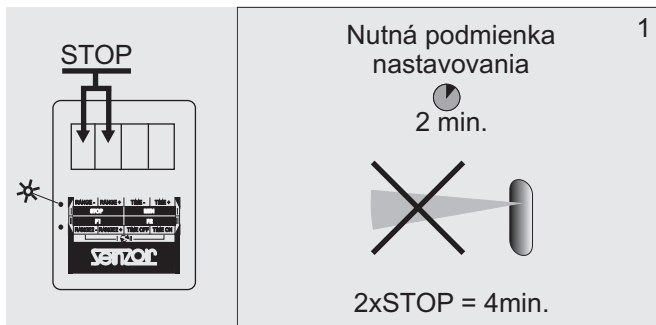

2.1. Nastavenie parametrov u snímačov:

TYP 9100, TYP 9200, WBS 2.2, WBS 2.2B, WBS 7.2, WBS 7.2B

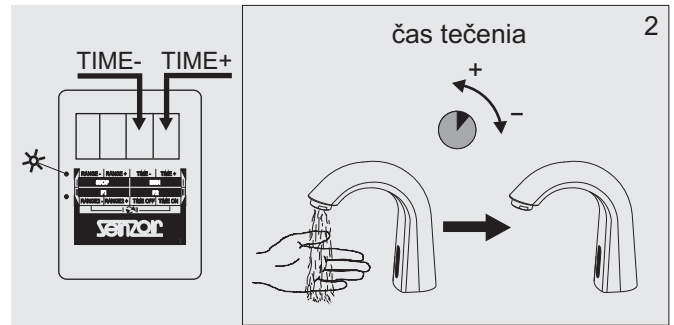
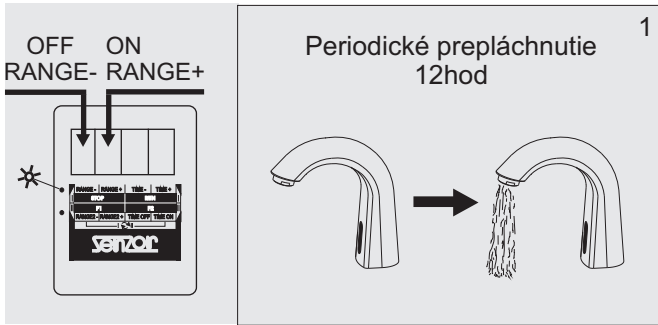

2.2. Nastavenie parametrov u snímačov:

WBS 3.1B, WBS 3.2B, WBS 3.1, WBS 3.2

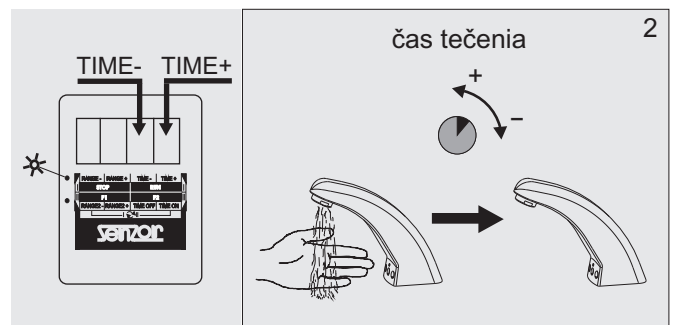
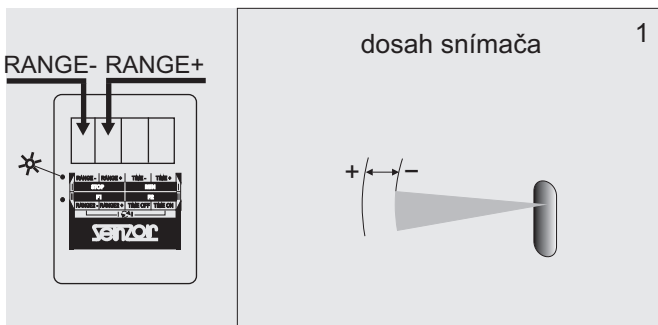

Iba WBS 3.1B, WBS 3.2B

2.3. Nastavenie parametrov u snímačov:

WBS 4.1B, WBS 4.2B

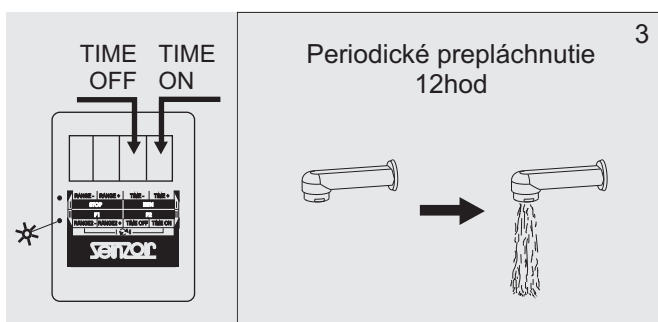
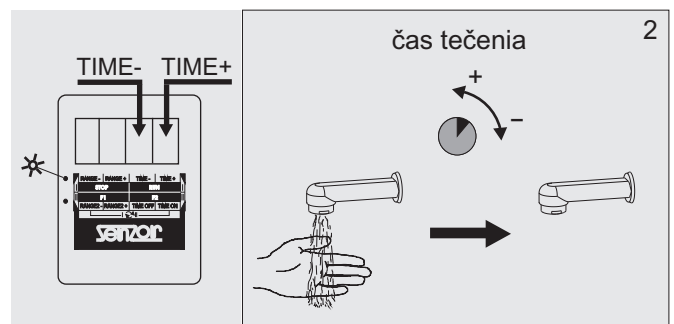
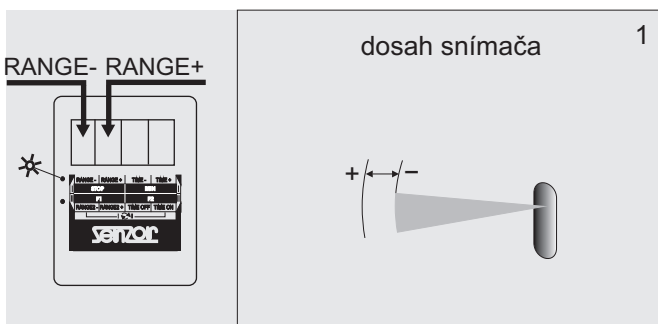

2.4. Nastavenie parametrov u snímačov:

APIS 4K1, APIS 4GK1, APIS 4.1, APIS 4B1,
APIS 5, APIS 5B, APIS D1B1, APIS KP, APIS KK, APIS P1

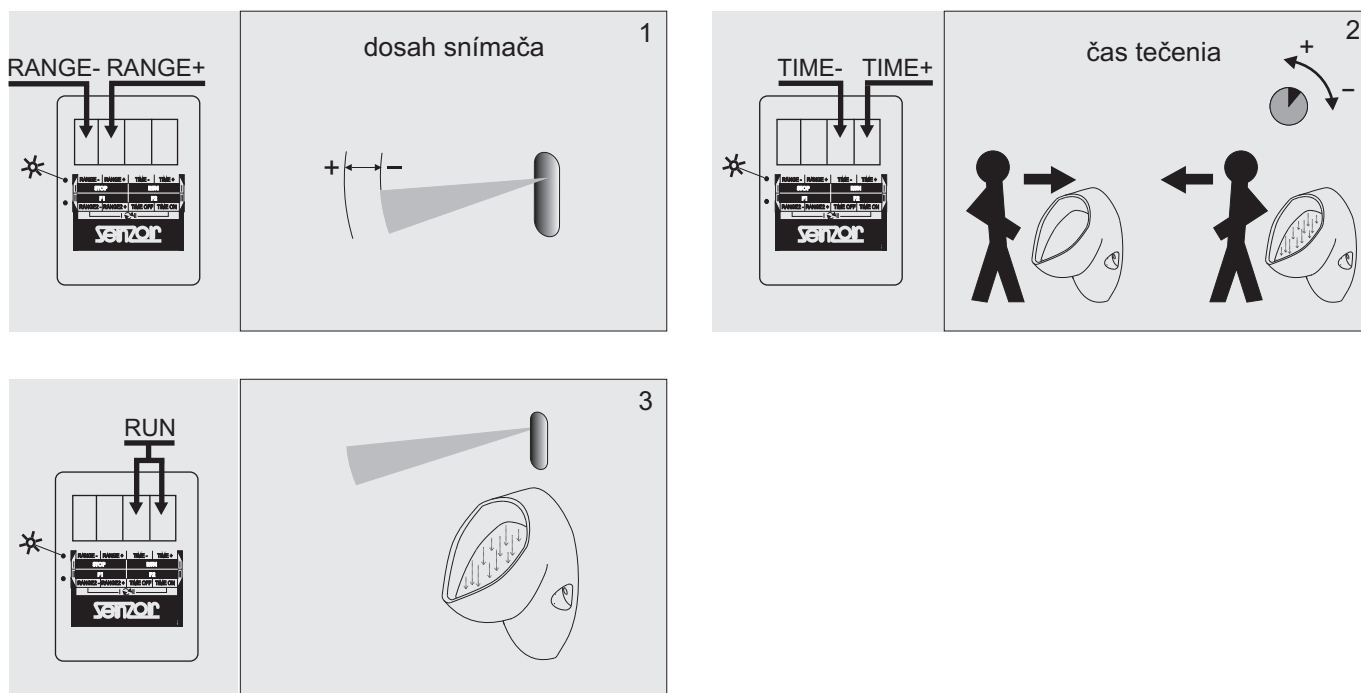

2.5. Nastavenie parametrov u snímačov:

SABA 2TLT, SABA 2TLTB, SABA 2NTB:

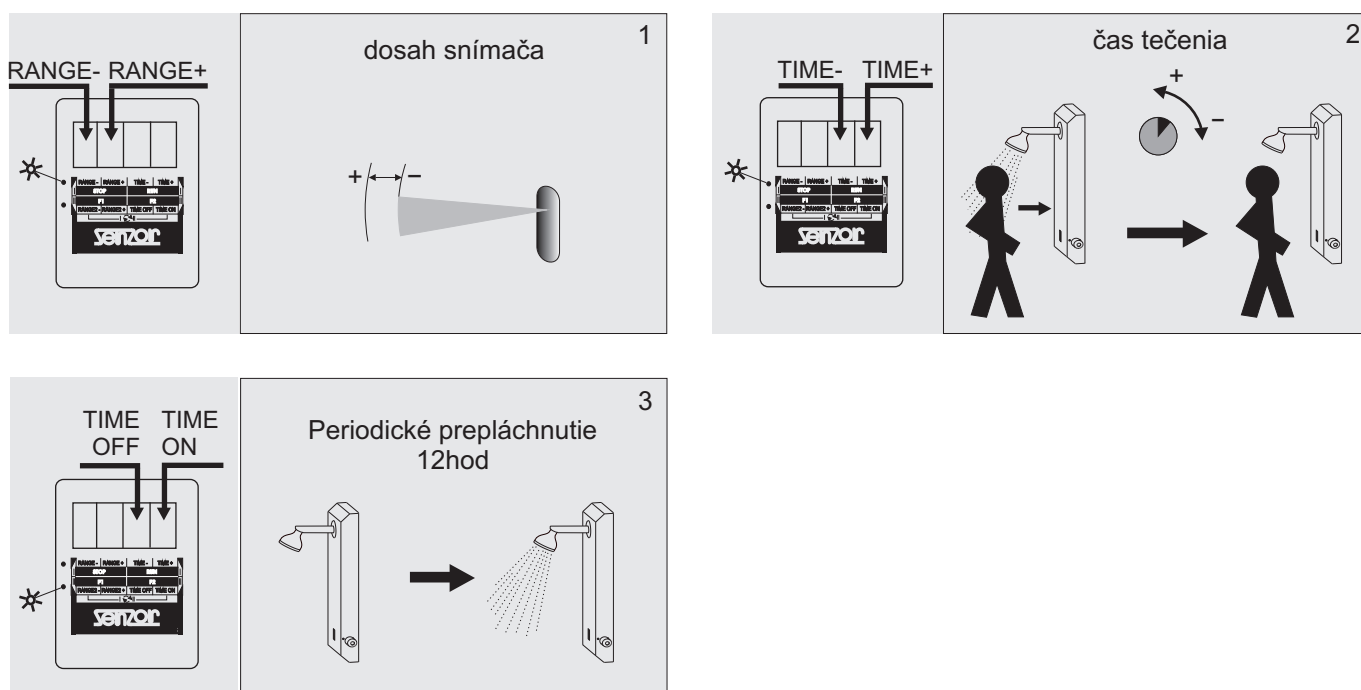

2.6. Aktivácia hygienického preplachu u snímačov:

SABA-2NTB.11R, WBS/SABA-P2, WBS-6PTL, WBS-P3, TYP6000B:

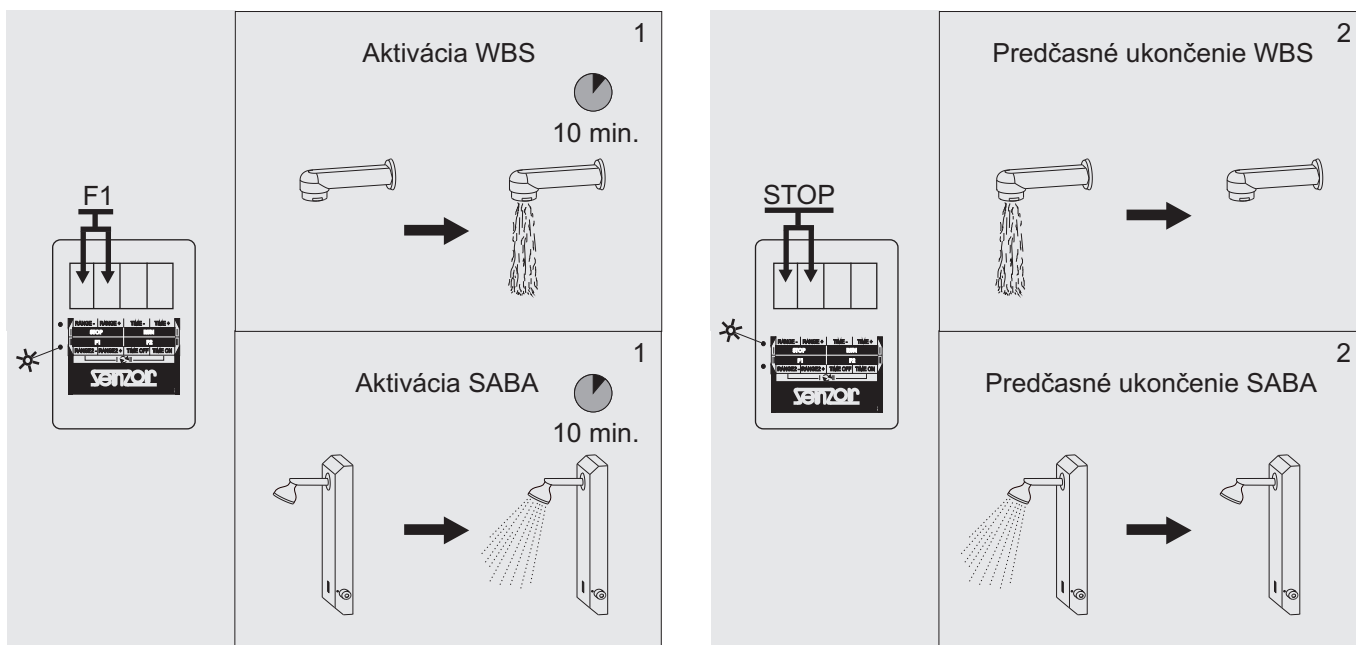

2.7. Nastavenie parametrov u snímačov:

APIS 1VBS

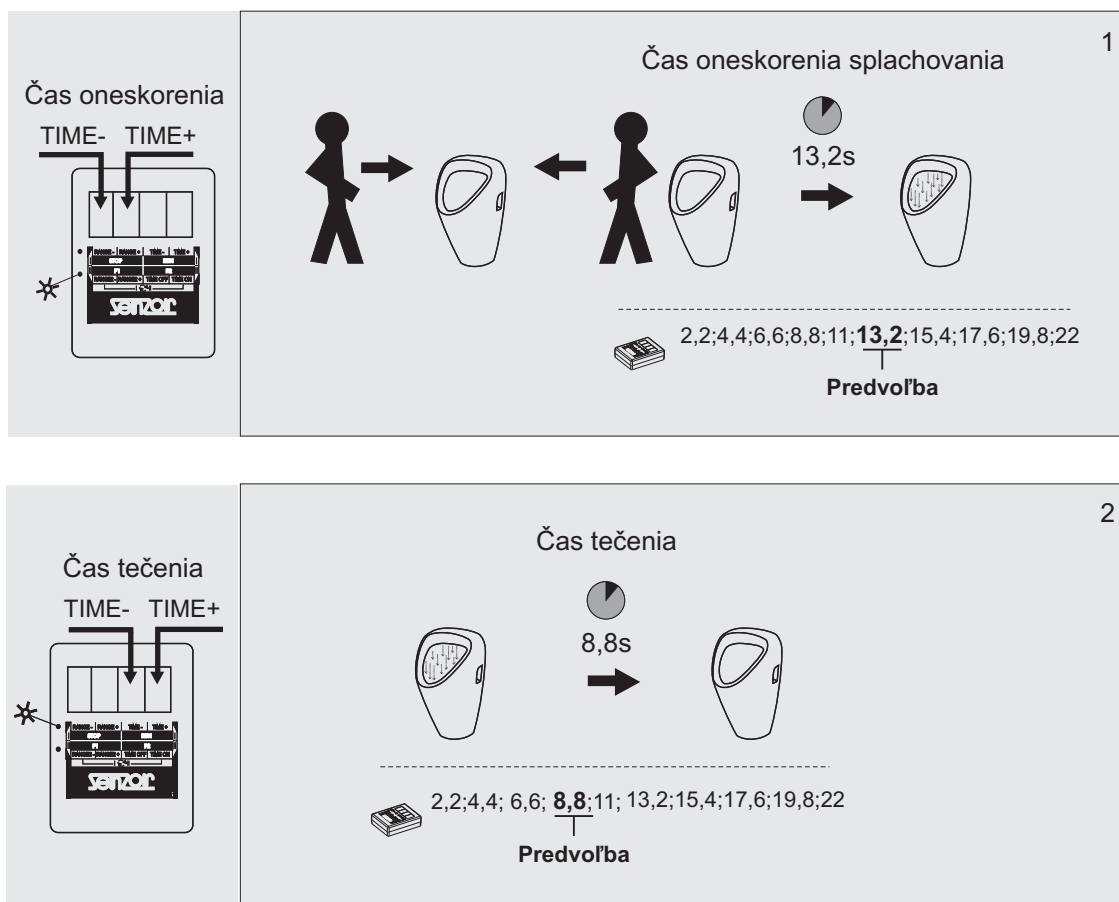

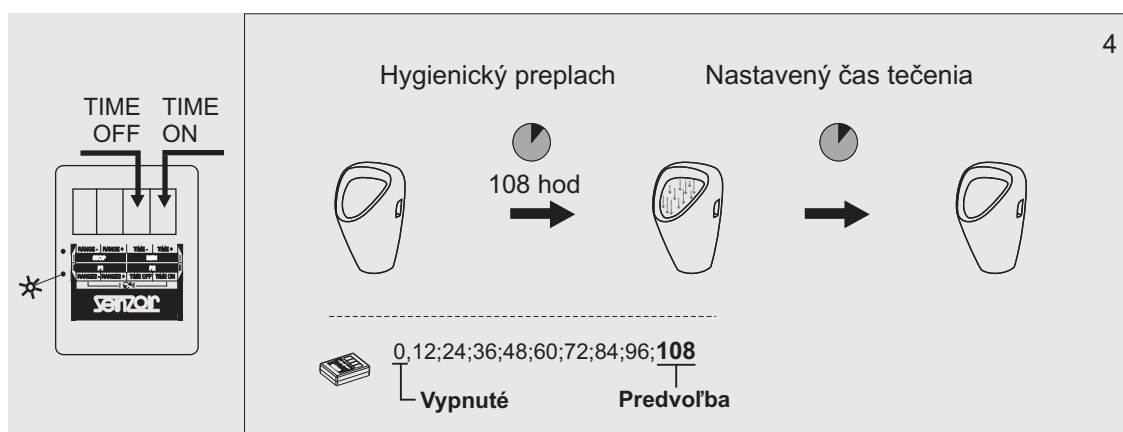
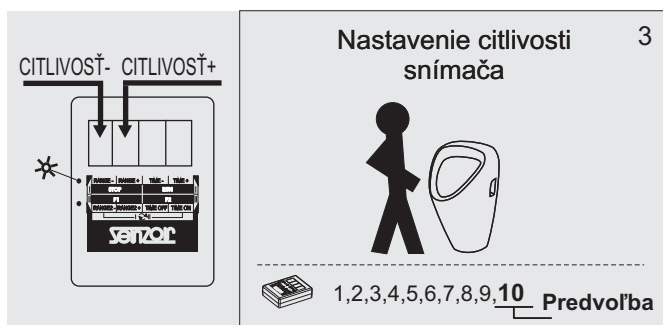

3. Dôležité upozornenia.

Diaľkové ovládanie musí byť nasmerované v priamom smere na oko senzoru.
 Pri správnom ovládaní diaľkového ovládania sa zmena na oku senzora potvrdzuje aj blikaním.
 Rýchle blikanie indikuje prepnutie do režimu stop, štart a dosiahnutie krajných hodnôt nastavenia.
 Slabá batéria ovplyvňuje činnosť diaľkového ovládania.